

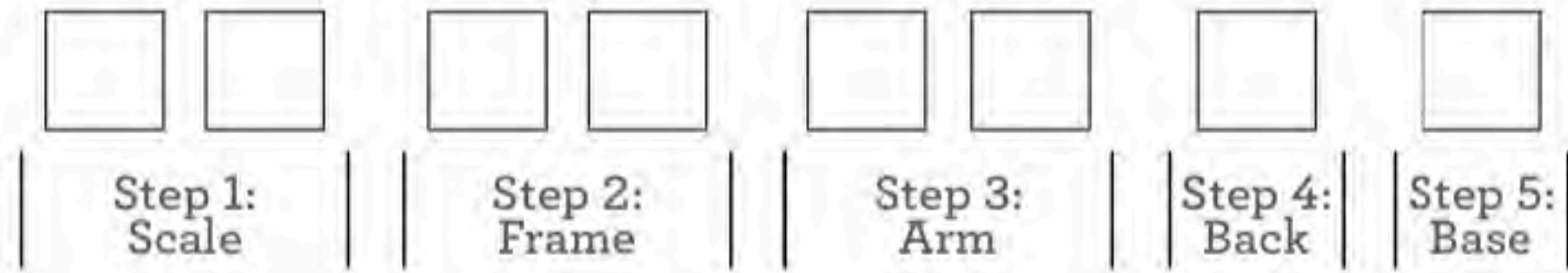

9600/9700 Design Your Own Series

All the Design Your Own Series frames are available in the traditional 96 series scale or the more generously scaled 97 series. The 96 or 97 prefix determines the scale of your Sofa, Chair or Sectional. You can then personalize your frame choice by selecting Arm, Back and Base options to suite your individual style.



1 Select Your Scale - - - -

96 or 97 Series number indicates your depth and height.



2 Select Your Frame Style - - -

*Note: All Frames are standard with Welt. 2 Weltless Options are available for an Up-Charge. Specify (Weltless: French-Seam) or (Weltless: Double Needle)
*L-Lawson Back Heights are approximately 2" lower than standard.

Chairs / Ottoman / Sofas:

- 01 - Chair
- 00 - Ottoman
- 11 - Chair & 1/2
- 10 - Large Ottoman
- 02 - Two Cushion 66" Loveseat
- 23 - Two Cushion 80" Sofa
- 33 - Three Cushion 80" Sofa
- 24 - Two Cushion 88" Sofa
- 34 - Three Cushion 88" Sofa

Sectional Pieces:

- LC - Left Arm Chair
- RC - Right Arm Chair
- LL - Left Arm Loveseat
- RL - Right Arm Loveseat
- LS - Left Arm Sofa
- RS - Right Arm Sofa
- LN - Left Arm Corner Sofa
- RN - Right Arm Corner Sofa
- LZ - Left Arm Chaise
- RZ - Right Arm Chaise
- LA - Left Angle Loveseat
- RA - Right Angle Loveseat
- AL - Armless Loveseat
- AC - Armless Chair
- SO - Sectional Ottoman
- SC - Sectional Chair
- CC - Curved Corner

Standard Construction

Arm Height: 25 in.
 Approximate Seat Height: 19 in.
 Standard Finish: Antique Walnut, Exposed Wood base
 Also available in any "Custom Line" Finish
 Skirted and Upholstered Bases are standard and only available in: Walnut
 *L - Lawson Back Heights are approximately 2" lower than standard.
 *Standard Throw Pillows are 21"x21"

96 - Series Dimensions

Height: 37 in.
Overall Depth: 38 in.
Seat Depth: 22 in.

97 - Series Dimensions

Height: 39 in.
Overall Depth: 41 in.
Seat Depth: 24 in.

3

Select Your Arm Style

* NOTE: All Arms are standard with welt.



**T-Cushion
Curved Front Base/Leg**

- B** - Bistro
- E** - English
- F** - Fan
- K** - Key
- M** - Modern
- N** - Narrow Track
- P** - Pleated
- R** - Rolled
- S** - Sock
- T** - Track



**T-Cushion
Square Front Base/Leg**

- BS** - Bistro Square
- ES** - English Square
- FS** - Fan Square
- KS** - Key Square
- MS** - Modern Square
- NS** - Narrow Track Square
- PS** - Pleated Square
- RS** - Rolled Square
- SS** - Sock Square
- TS** - Track Square



**Arm to the Front
Square Front Base/Leg**

- BF** - Bistro Front
- CF** - Crescent Front
- EF** - English Front
- FF** - Fan Front
- KF** - Key Front
- LF** - Large Crescent Front
- MF** - Modern Front
- NF** - Narrow Track Front
- PF** - Pleated Front
- RF** - Rolled Front
- SF** - Sock Front
- TF** - Track Front

4

Select Your Back Style

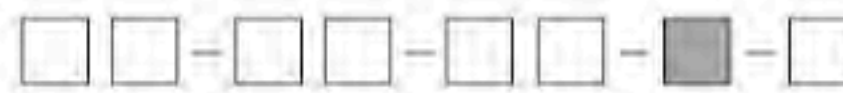

B - Box (Loose)



K - Knife (Loose)



A - Attached Box



S - Semi-Attached Knife



L - Lawson*



T - Tight



C - Casual Back (Loose)

5

Select Your Base Style

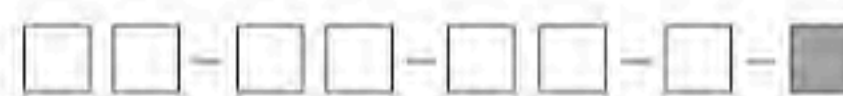

S - Skirt



D - Dressmaker



U - Upholstered



B - Bun
Foot Height = 2"



W - Wood Foot
Foot Height = 2"



L - Large Tapered Block
Foot Height = 2"



T - Tapered
Foot Height = 2"



H - High Tapered
Foot Height = 4"



G - Grand Turned
Foot Height = 4"

9600/9700 Frame Styles

Note: All dimensions are approximate and will vary slightly based on Options.
 Sketches shown in 1/4" scale

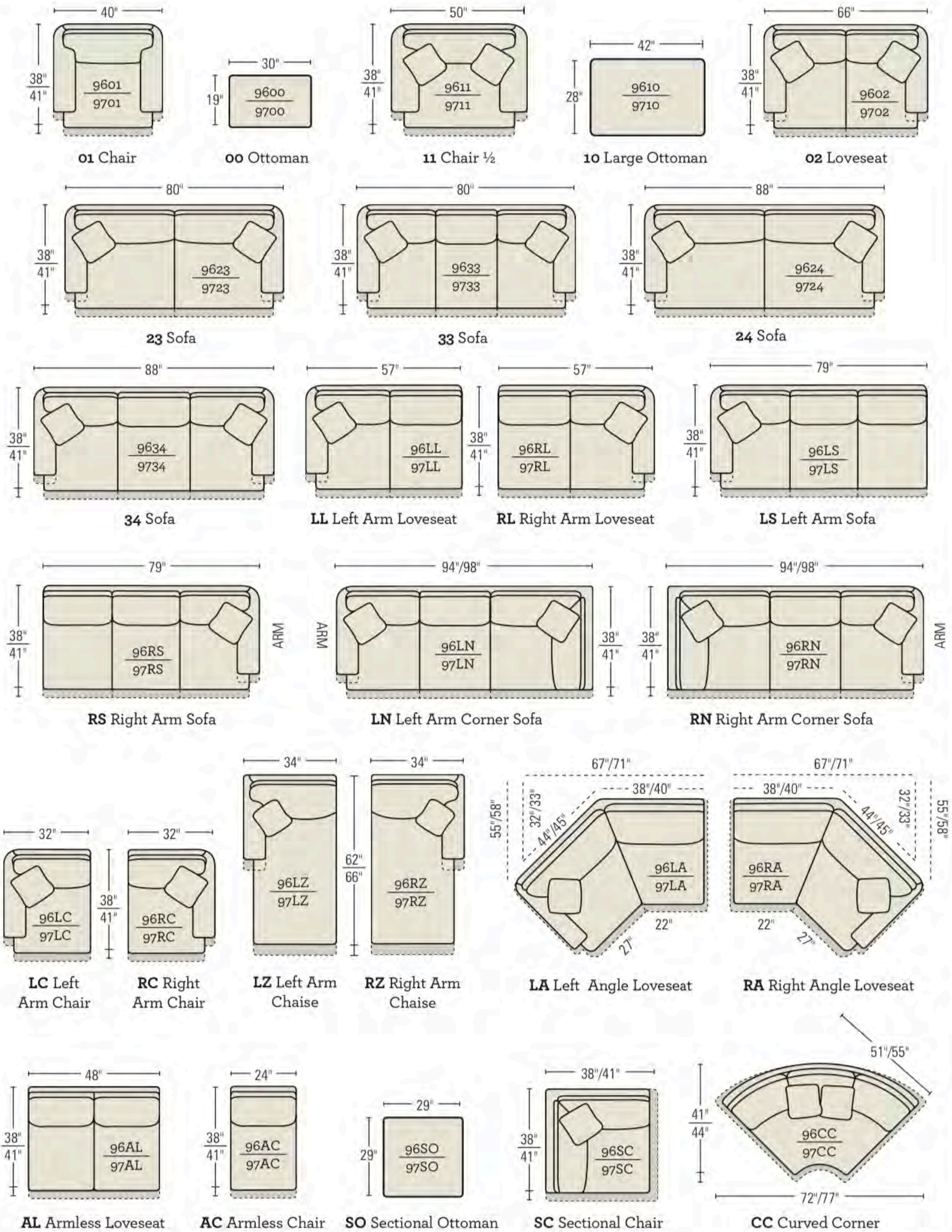

96/97-SECTIONALS - POPULAR CONFIGURATIONS - Scale 1/4" = 1'

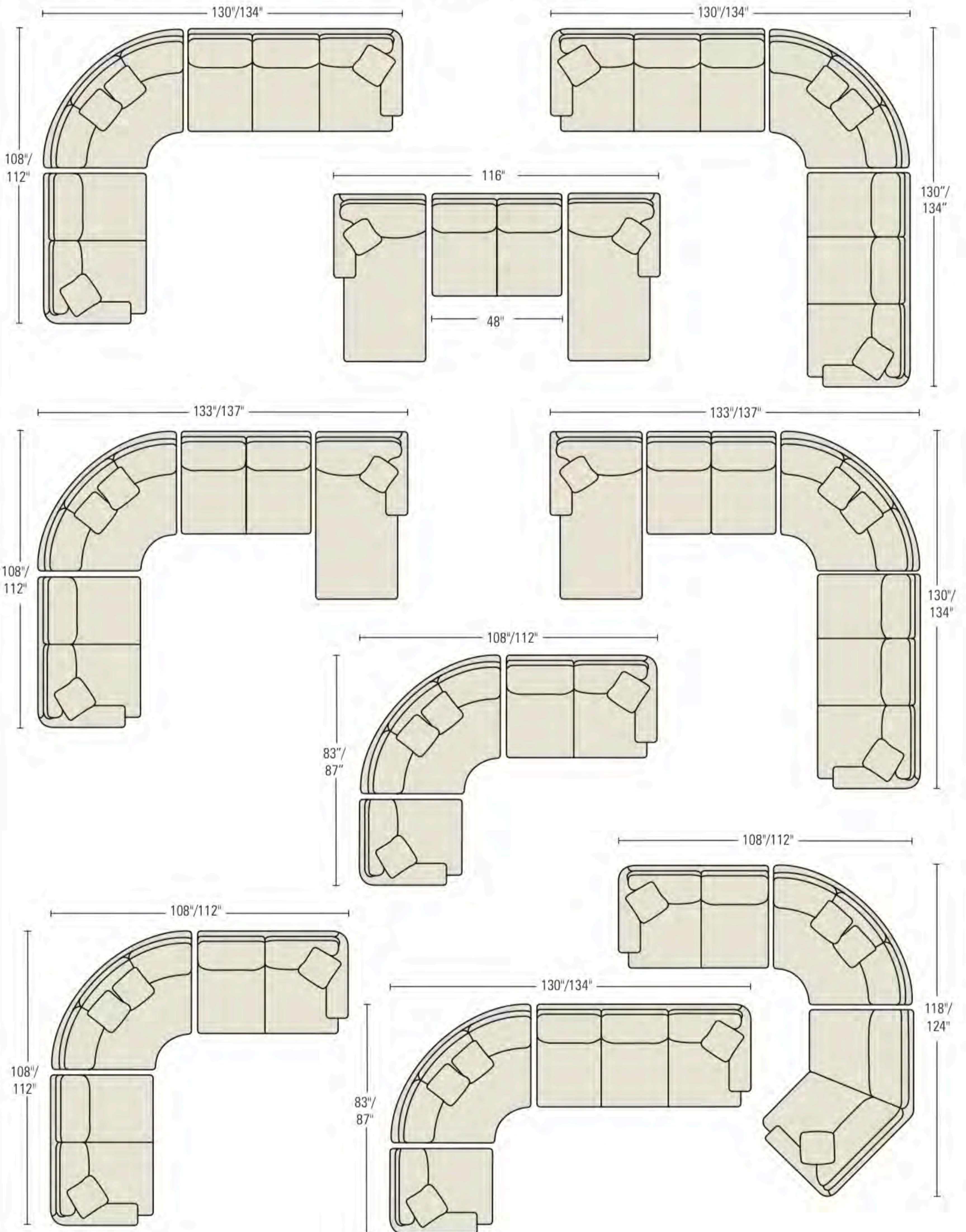

96/97-SECTIONALS - POPULAR CONFIGURATIONS - Scale 1/4" = 1'

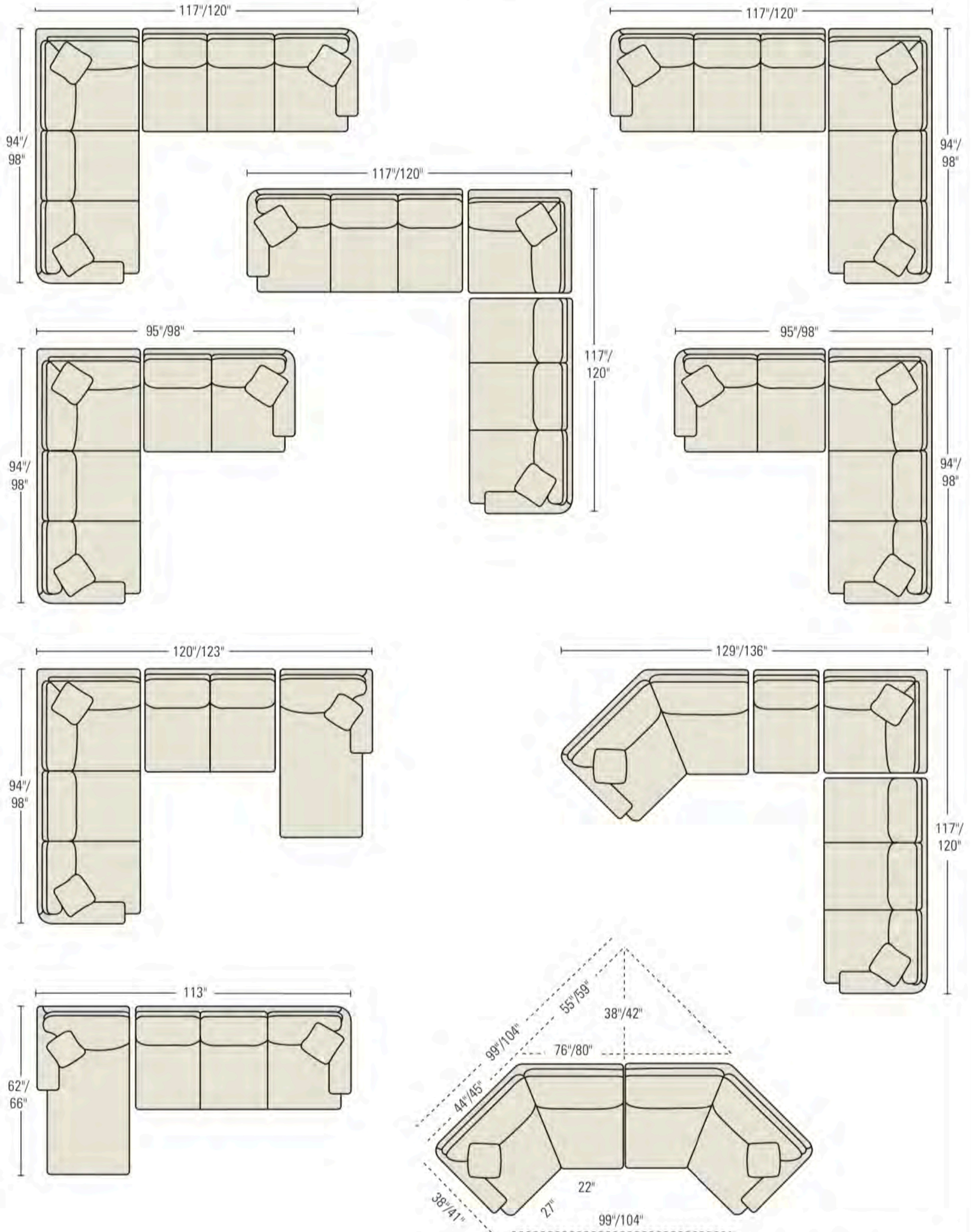

ARM OPTIONS

T-Cushion Arm Options

□■ - T Cushion with Curved Front Base/Leg

□S - T Cushion with Square Front Base/Leg



B-Bistro
BS-Bistro/Square (Shown)



E-English (Shown)
ES-English/Square



F-Fan
FS-Fan/Square (Shown)



K-Key
KS-Key/Square (Shown)



M-Modern
*MS-Modern/Square (Shown)



N-Narrow Track (Shown)
NS-Narrow/Square



P-Pleated (Shown)
PS-Pleated/Square



R-Rolled (Shown)
RS-Rolled/Square



S-Sock (Shown)
SS-Sock/Square



T-Track (Shown)
TS-Track/Square

Arms to the Front Arm Options

☐ F - Arms to the Front

All Standard with Square Front Leg/Base



BF-Bistro Front



CF-Crescent Front
(Only available to the Front)



EF-English Front



FF-Fan Front



KF-Key Front



* LF-Large Crescent Front
(Only available to the Front)



MF-Modern Front

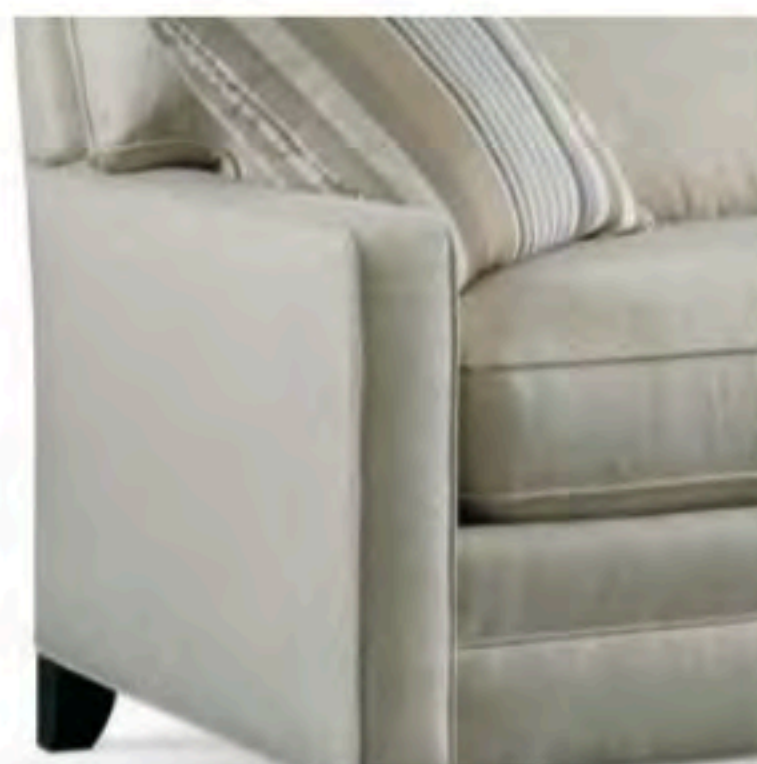

NF-Narrow Track Front



PF-Pleated Front



RF-Rolled Front



SF-Sock Front



TF-Track Front

* NOTE Arm shown with Weltless French Seam option. All Arms are standard with welt.

BACK OPTIONS



B-Box Loose



K-Knife Loose



A-Attached Box (Semi)



**C-Casual
(Only Available Loose)**



**S-Semi Attached
Knife Edge**



T-Tight



L-Lawson*

* L - Lawson Back option will lower back height approximately 2 inches.

BASE OPTIONS

	T-TAPERED Foot Height = 2"	L-LARGE TAPERED BLOCK Foot Height = 2"	W-WOOD Foot Height = 2"	H-HIGH TAPERED** Foot Height = 4"	G-GRAND TURNED** Foot Height = 4"
When using "T" Cushion					
When using Arms to the Front					

**Base Options H and G will raise seat height approximately one inch.

Two Weltless Options

Available for an upcharge. "Weltless: Double Needle" and "Weltless: French Seam".
This option must be specified on your order as "Special Application"



Weltless: Double Needle



Weltless: French Seam

9701-MSBD CHAIR

OPTIONS SHOWN:

97: 47" Depth

01: Chair

MS: Modern/Square Arm

B: Box (Loose) Back

D: Dressmaker Skirt

Special Application:

Shown with "Weltless French Seam"



Weltless French Seam

BASE OPTIONS

	S-SKIRT	D-DRESSMAKER	U-UPHOLSTERED	B-BUN
When using "T" Cushion				
When using Arms to the Front				

*Note: Arms to the front will square the front corner/base (see examples)